

DANCE SQUARE, LONDON, EC1V

1 BED APARTMENT

£425,000
LEASEHOLD

A beautifully presented one-bedroom apartment positioned on the second floor (with lift access) of the highly sought-after Dance Square development, ideally located in the heart of Clerkenwell, EC1V.

This stylish home is offered in excellent condition throughout and provides bright, well-balanced accommodation. The property features a spacious reception room, a contemporary fitted kitchen with integrated appliances, a generous double bedroom, and a modern bathroom. Large windows allow for excellent natural light, creating a calm and welcoming living environment.

Residents of Dance Square benefit from a range of premium amenities, including a concierge service, secure entry and beautifully maintained communal gardens, offering a peaceful retreat within this vibrant central London setting.

Hemmingfords

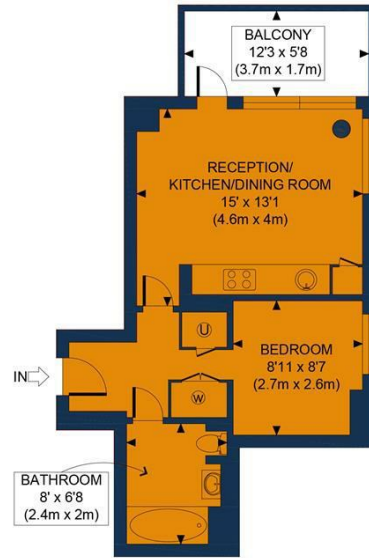

SECOND FLOOR
GROSS INTERNAL
FLOOR AREA 397 SQ FT

APPROX. GROSS INTERNAL FLOOR AREA 397 SQ FT / 37 SQM

Disclaimer: Floor plan measurements are approximate and are for illustrative purposes only. While we do not doubt the floor plan accuracy and completeness, you or your advisors should conduct a careful, independent investigation of the property in respect of monetary valuation

Dance Square

date 14/04/26

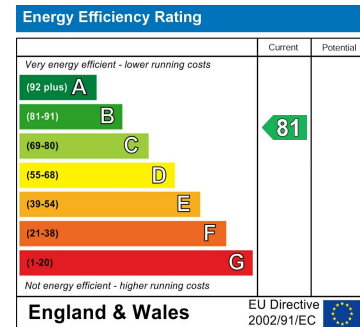
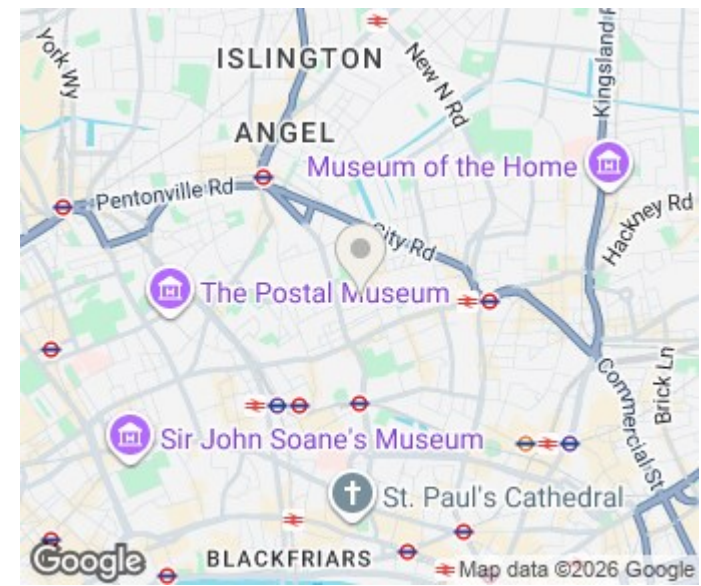

Agents Note: Whilst every care has been taken to prepare these particulars, they are for guidance purposes only. All measurements are approximate and are for general guidance purposes only and whilst every care has been taken to ensure their accuracy, they should not be relied upon and potential buyers/tenants are advised to recheck the measurements

Hemmingfords Sales
34 Upper Street
London
N1 0PN

02038907470
info@hemmingfords.co.uk
www.hemmingfords.co.uk

Hemmingfords